

Selfie Wizard

Version: 48

Your Serial Number:

Important information – please read before first use

- **Use the supplied power adaptor only.**
The use of any other power source WILL result in data corruption and permanent damage to the unit and **voids the warranty.**
- **The Wizard/Ninja has a built-in UPS (Uninterruptible Power Supply)** to perform a safe shutdown on loss of power. It must be allowed to fully shutdown, approximately 1 minute until ALL lights go off before reapplying power to restart.

Selfie Wizard Version

- **Admin Password** is all lowercase: **swiz**
- **When using a Display Device** – Plug in and power ON the TV BEFORE applying power to the Selfie Wizard to enable HDMI output.

Ninja Version

- **WiFi Password is: 12345678**

Instructions & Support

- Full Instructions, How-To's and Promotional Material are available from the Owner Area of the main website: **SelfieWizard.com/owner-area**
- **The Owner Area is password protected, use all lowercase: swiz**

- **Have you joined the Selfie Wizard Owners Group..?**

For the fastest response to support enquiries, all the latest News, Tips, Tricks and Idea Sharing:

Facebook.com/groups/SelfieWizard

Whats in the Kit

- Wizard Print & Display Server or Ninja Print Server
- International Universal Power Supply
- RED Data Plug (required for Printing)
- 2.4ghz External Antenna
- Antenna Extension Cable 2mtr
- HDMI Display Cable 2mtr (Wizard Only)
- Quick Start Guide

Quick Start

- 1) Connect WiFi Antenna
- 2) **Wizard only** – Use the supplied HDMI Cable to plug in TV.
Always power on TV before applying power to the Wizard.
- 3) Connect Power Adapter to Ninja/Wizard
- 4) Connect your Phone to the Ninja/Wizard Wi-Fi Network

Ninja: WiFi password is: 12345678

Wizard: No password required

- 5) Open a **web browser** on your Phone (Not Google)
To access the admin menu enter: **admin/** OR **10.10.10.10/admin/**
The Wizard Admin password is: swiz
- 6) The Admin Menu provides access to all the features of the unit.

Shut down

Simply turn off/remove power.

The built in UPS system will perform a safe shut down after approximately 1 minute of removing power from the unit.

Rebooting

Simply turn off/remove power.

The Ninja/Wizard **MUST** be allowed to shutdown completely – All lights off **BEFORE** reapplying power.

Printer Setup

The printing system is pre-loaded with drivers for all compatible Printers.

Each Printer will require one time initial setup. To enable printing the **RED** Data Plug must be inserted and remain attached to the Ninja/Wizard

To install and setup your Printer please follow these instructions carefully

- With the unit switched on, plug in the Printer USB
 - Turn Printer on
 - From the Main Menu select **'Printer Setup' >> 'Printers'**
1. Select **'Add Printer'**



Local Printers: will display the currently connected printer(s)

'Check' against the printer to set up then click **'Continue'**

2. TIP: Give your Printer a friendly name, description and location.
All other settings can be left as they are, then **'Continue'**

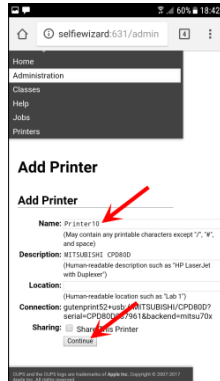

3. From the Model list select your Printer Model – then **'Add Printer'**

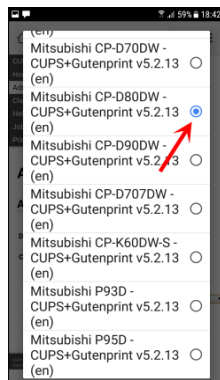

4. Adjust **Media Size** if required – then **'Set Default Options'**

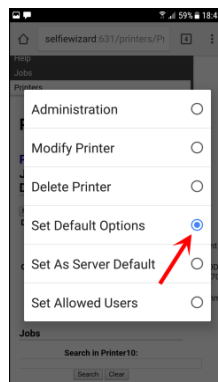
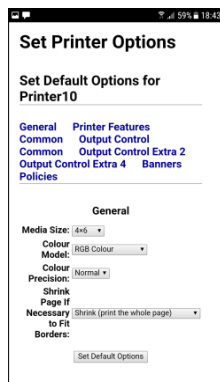

The printer is now added to the system

5. From the '**Administration**' drop down select '**Set As Server Default**'

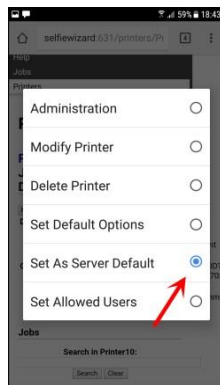

6. From the '**Maintenance**' drop down select '**Print Test Page**'
The Printer will now print a Test Page and will be correctly set up for Automatic Printing

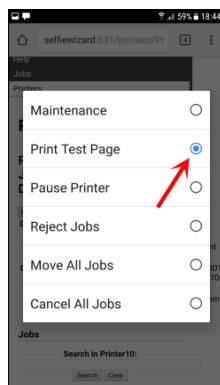

Installed printers will be available as AirPrint Printers to any iOS device connected to the Ninja/Wizard. No further setup is required to AirPrint.

Wizard Version Only

Guest Photo Upload

1. **Connect phone to Wizard WiFi network.**

Some versions of iOS and Android may complain about lack of internet connection as it is purely a local WiFi network with no external data connection, simply ignore this.

2. **Using the web browser, Safari, Chrome, FireFox etc.**

Navigate to: selfie/

The trailing slash / on the URL is important. It tells the browser that it is a local connection and not to try to do an internet search for the entered URL.

Some Huawei phones ignore standard DNS protocols.

To access the Guest Upload page use: 10.10.10.10/

Google is NOT a web browser

3. Follow the onscreen instruction to upload images from your phone.

Common Problems

No TV Display with Wizard:

The TV must be connected to the Wizard and switched on BEFORE applying power to the Wizard. Remove power from the Wizard for 1 minute and allow to reboot.

Not able to connect to Ninja/Wizard Wifi:

From Startup/Reboot – The most likely cause will be Wi-Fi interference from other equipment in the vicinity. Typically WDMX Uplighters, Radio Microphones, Venue Wi-Fi.

A change of Wi-Fi channels may resolve the problem.

Mid-event – On rare occasions Wi-Fi may become unresponsive or refuse new connections. Reboot the Selfie Wizard by removing power for 1 minute. Wait till all lights on the unit have gone out and apply power again.

Guest Phone Connections

The most frequent problem is simply guests not following the 2 step process

1. Connect to the Selfie Wizards Wifi Network
2. In the phone's web browser enter: **Selfie/** or **10.10.10.10/**

Things to check for

- Turn Mobile Data OFF
This forces the phone to use the WiFi connection
- Google Search box – is **NOT a web browser** but a Search Engine that will try to retrieve internet search results
- iPhones – uploads from cloud storage is only possible if the Selfie Wizard is connected to an internet connection. Guests will need to upload images that are actually stored on the iPhone.
- Huawei – Sony – Onetel
Some models from these manufacturers do not follow standard DNS protocols. Turning Mobile Data OFF and using the 10.10.10.10/ access URL will work.

Selfie Wizard Ltd
Bolnore
Newbridge
Cadnam
Southampton
SO40 2NW
United Kingdom

www.SelfieWizard.com

mail@SelfieWizard.com

Notes: